

REVISIONS		APPROVED					
ZONE	REV	DESCRIPTION	DATE	DRT	CHK	ENG	PA

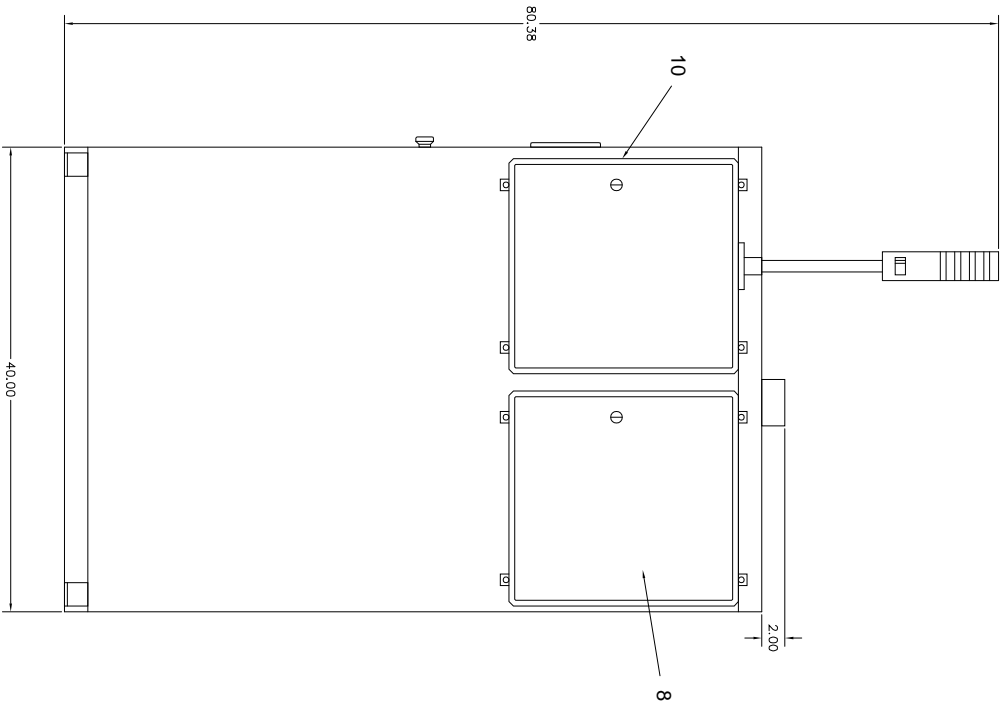
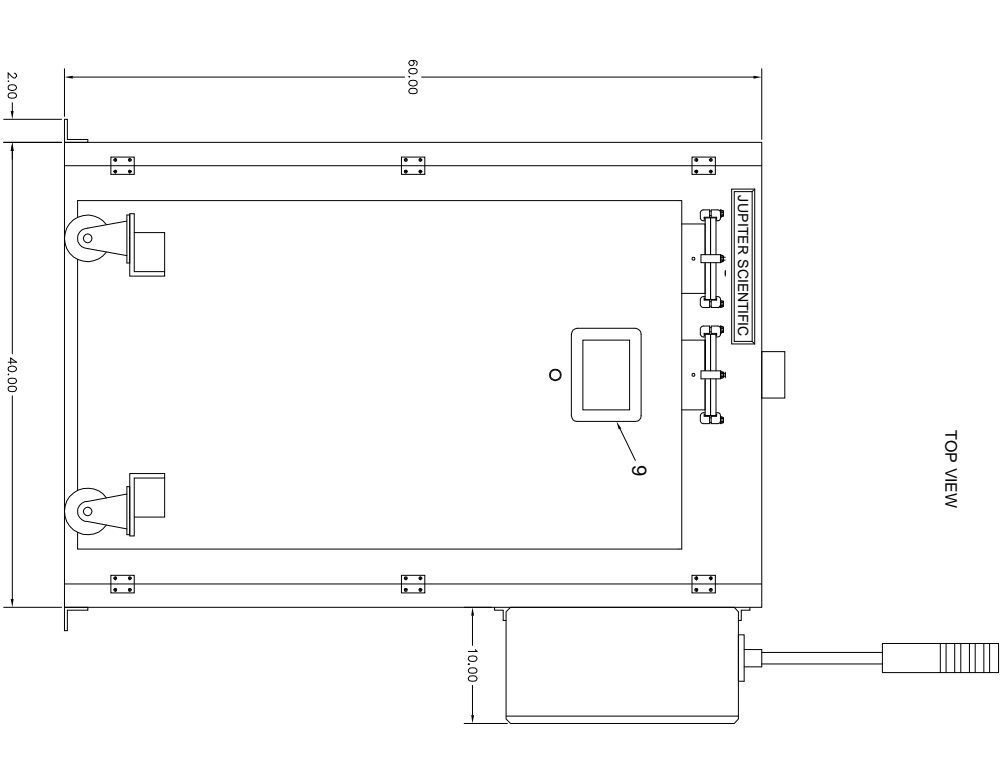
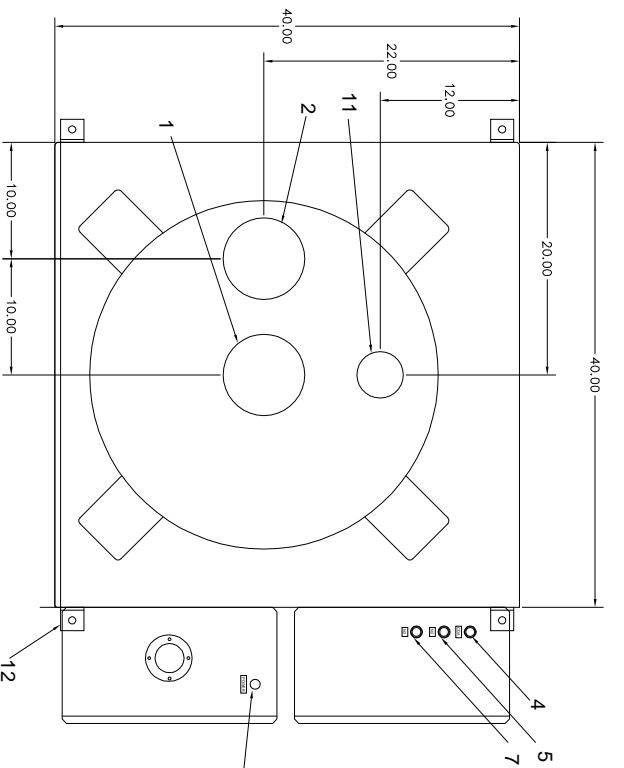

ITEM	DESCRIPTION	FACILITY REQUIREMENT	REMARK
1	PROCESS GAS INLET	NW160 FLANGE, SS	6" O.D. TUBE (NOMINAL)
2	PROCESS GAS OUTLET	NW160 FLANGE, SS	6" O.D. TUBE (NOMINAL) (Exhaust Out=In)
3	POWER INLET	115 VAC, 1 PHASE, 60 HZ, 7 A	
4	N2 INLET PORT, PURGE	3/8" SWAGelok, SS, 60-80 PSI	User Discretion (to purge canister - recommended 25 CFM)
5	N2 INLET PORT	1/4" SWAGelok, SS, 60-80 PSI	User Discretion (to purge canister - recommended 25 CFM)
6	ACCESS DOOR		
7	N2 INLET PORT, PNEUMATICS	1/4" SWAGelok, SS, 60-80 PSI	User Discretion (to purge canister - recommended 25 CFM)
8	FLOWMETER/VALVE BOX		
9	GU / LCD SCREEN		
10	ELECTRICAL BOX ACCESS PANEL		
11	CABINET EXHAUST PORT	4" DIA OD COLLAR	150-450 CFM
12	ANCHOR HOLES	0.6 DIA. THRU HOLE (4X)	

NOTES:
1. CABINET DOOR AND TOP PANEL ARE SHOWN AS TRANSPARENT TO SHOW CANISTER POSITION.

JUPITER SCIENTIFIC
 Custom Air Pollution Control Equipment
EUROPA WITH CABINET

SIZE: 03-0056
 ORDER# : 03-0056R0
 DATE: 03-0056R0
 SHEET: 2 OF 2

APPROVED: [Signature]
 DATE: [Date]

DRAWN: G. DORAN
 CHECKED: [Signature]

MATERIAL: [Material]
 FINISH: [Finish]

PARTS LIST: THIS DOCUMENT CONTAINS INFORMATION PROPRIETARY TO JUPITER SCIENTIFIC AND SHALL BE KEPT CONFIDENTIAL. NO PARTS SHALL BE REPRODUCED OR MANUFACTURED IN WHOLE OR IN PART WITHOUT CONSENT OF JUPITER SCIENTIFIC.

DIMENSIONS: UNLESS OTHERWISE SPECIFIED DIMENSIONS ARE IN INCHES. TOLERANCES ARE: FRACTIONS: XX ± 0.02 ANGLES: ± 1° DECIMALS: .XXX ± .005

DO NOT SCALE DRAWING